

## E.C.A. STAR SHOWER MIXER

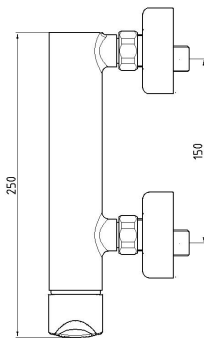
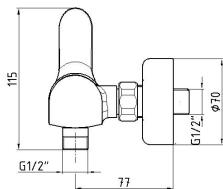

Product Description	
Product Number	102154016EX
Product Name	Shower Mixer
EAN Barcode	8693261054626

Technical Specification	
Cartridge Type	Ø35 mm Ceramic Cartridge
Min. Water Pressure	0,5 bar
Max. Water Pressure	10 bars
Recommended Water Pressure	3 bars
Nominal Flow Rate @3bars	12,4 l/m
Inlet Water Temperature	5°C - 65°C
Supply Connection	G 1/2" S-Unions
Finishing	Chrome
Body Material	Brass

Product Variants	
102154016STEX	Shower Mixer Water Saving 8 l/m
102154016xx	xx Localization Product Number

**Flow Rate Chart**

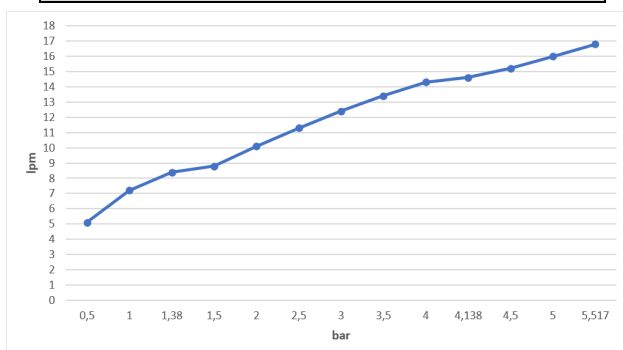

January 2021

We reserve the right to alter product specification and colors and to make technical modifications without prior notice.

[www.ECA.com.tr](http://www.ECA.com.tr)